

The homesite for Lot 124 is uniquely positioned on a peninsula in a wetland that surrounds the site across the South. The southern lot line is comprised mostly of mature oak trees, with broad prairie views from the Southwest through the Northwest to the Northeast.

Marketing Lot Number Lot 124

Lot Characteristics
Lot Area 6.15 Acres

Site Restrictions
Setbacks Front - 65'
Rear - 55'
Side- Interior - 20'
Side- Corner - 65'
Easements Refer to site plan for easements
10' utilities easement along each property line
Wetland Buffers Refer to site plan for boundary

Notes
See design guidelines for additional information
See City of Grant Zoning and Building Code for additional information and requirements

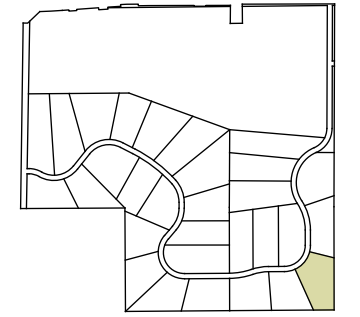
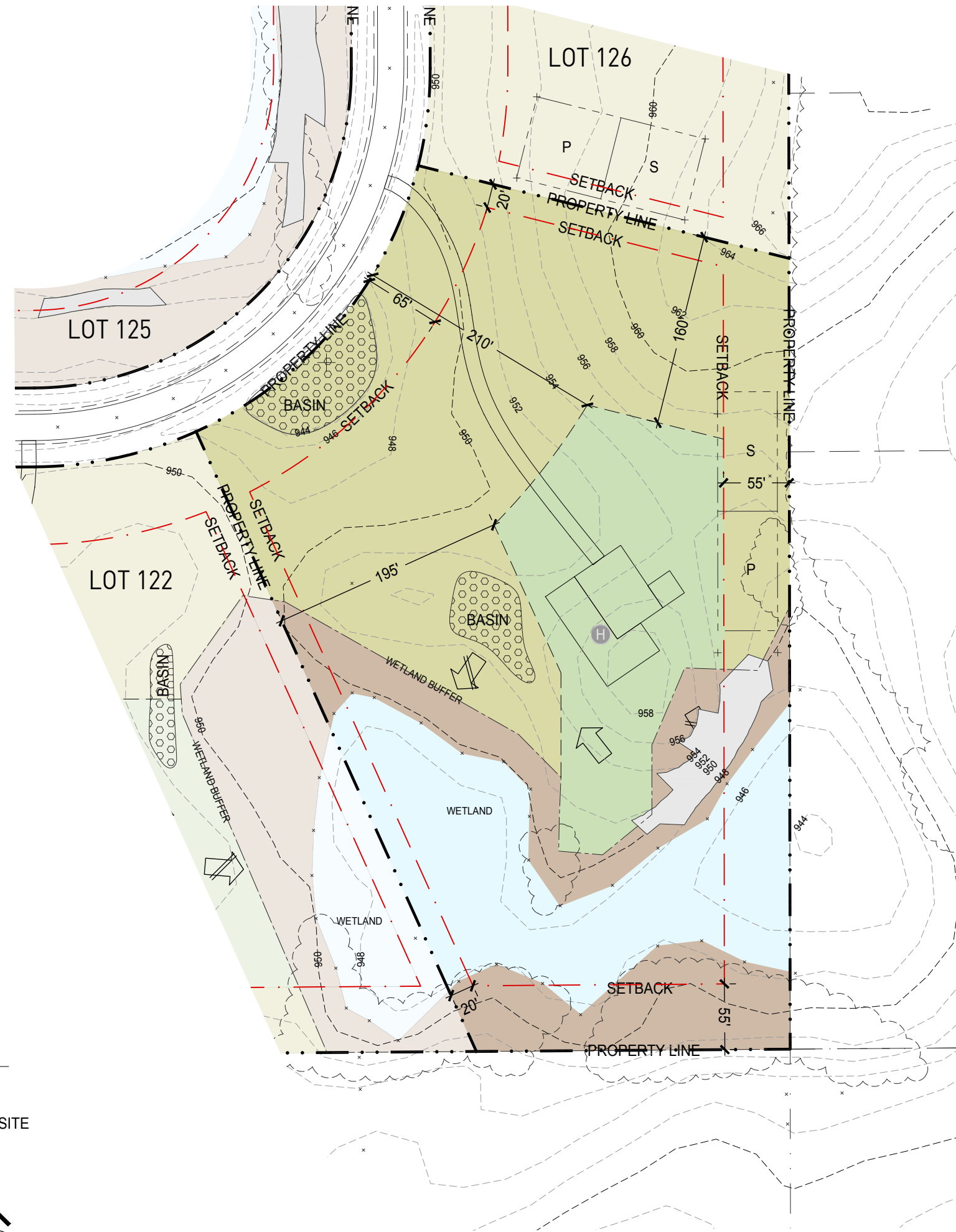







WHITE OAKS SAVANNA
County Road 12 and Lake Elmo Avenue
whiteoakssavanna.com

LOT 124

MAX HOMESITE AREA:
1/2 ACRE

LOT KEY

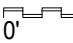
	NATURAL AREA MAINTAINED BY HOA
	WETLAND AREA DESIGNATED BY BCWD
	LOT IMPROVEMENT AREA TO LOCATE HOMESITE
	INFILTRATION BASINS REQUIRED BY BCWD
	INTENDED WATER MANAGEMENT
	EX. TREE LINE FOR REFERENCE ONLY
	TESTED PRIMARY/SECONDARY SEPTIC
	SITE HAY BALE MARKER

VERSION 1: 02/09/2022 NOT FOR CONSTRUCTION. THE DEVELOPERS RESERVE THE RIGHT TO AMEND ANY ASPECT OF THESE TECHNICAL LOT DRAWINGS AT ANYTIME WITHOUT PRIOR NOTICE. TOPOGRAPHICAL INFORMATION FOR CONCEPTUAL DESIGN PURPOSES ONLY.

0' 50' 100'

