

Lot 120 is nestled into a grove of trees on its South and West lot lines creating a sense of privacy. The likely homesite sits above a seasonal wetland to the North. Commanding views towards the woods, and prairie views to the North, Northeast, and East.

Marketing Lot Number	Lot 120
Lot Characteristics	
Lot Area	5.32 Acres
Site Restrictions	
Setbacks	Front - 65' Rear - 55' Side - Interior - 20' Side - Corner - 65'
Easements	Refer to site plan for easements
Wetland Buffers	10' utilities easement along each property line Refer to site plan for boundary
Notes	
	See design guidelines for additional information See City of Grant Zoning and Building Code for additional information and requirements

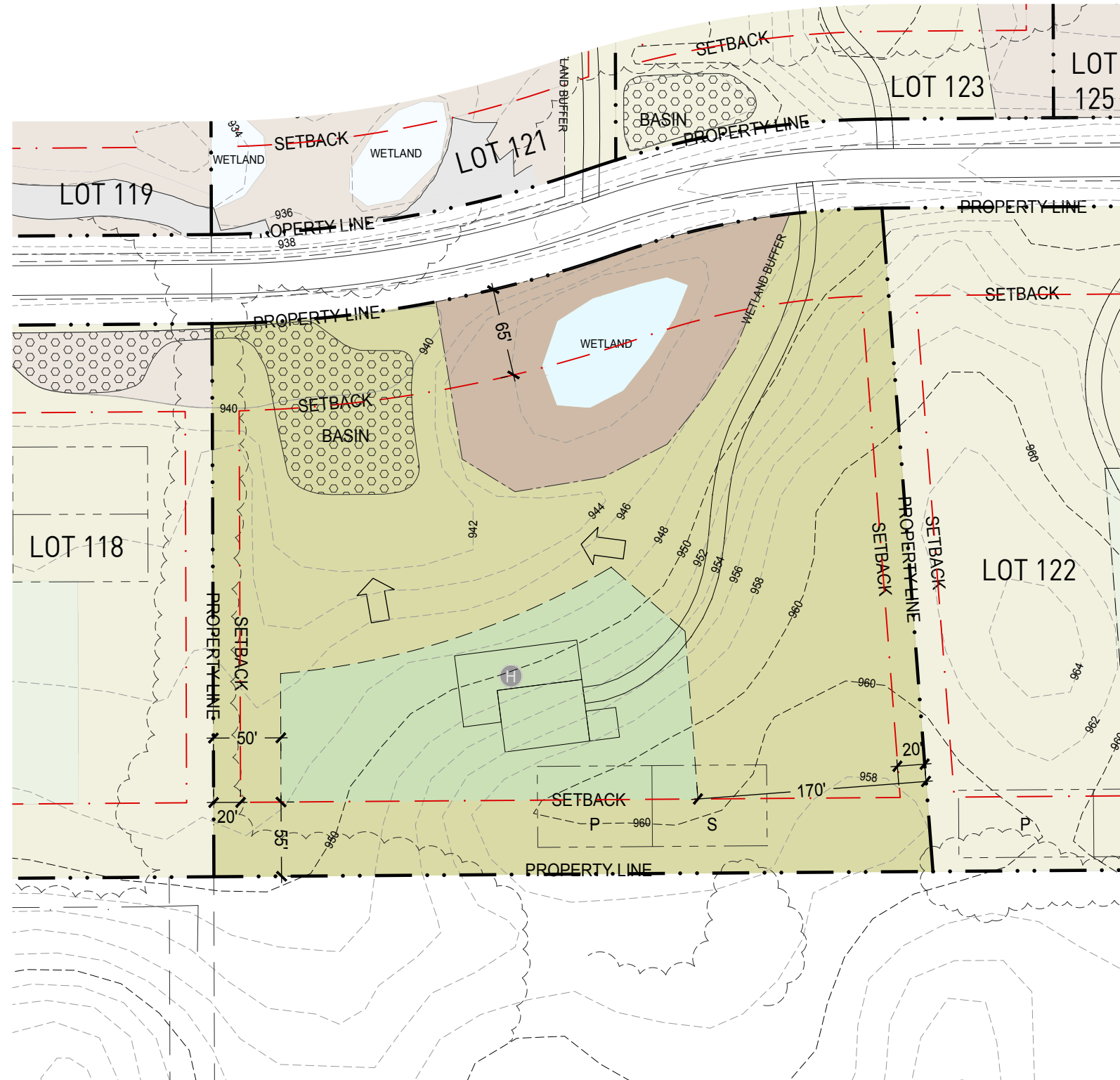

MAX HOMESITE AREA:
1/2 ACRE

LOT KEY	
	NATURAL AREA MAINTAINED BY HOA
	WETLAND AREA DESIGNATED BY BCWD
	LOT IMPROVEMENT AREA TO LOCATE HOMESITE
	INFILTRATION BASINS REQUIRED BY BCWD
	INTENDED WATER MANAGEMENT
	EX. TREE LINE FOR REFERENCE ONLY
	TESTED PRIMARY/SECONDARY SEPTIC
	SITE HAY BALE MARKER

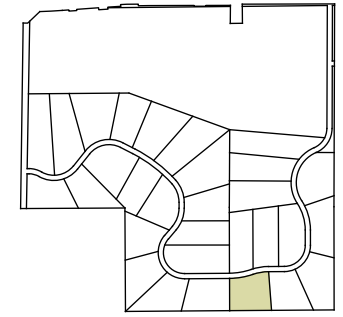
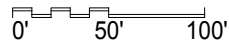

WHITE OAKS SAVANNA
County Road 12 and Lake Elmo Avenue
whiteoakssavanna.com

LOT 120

VERSION 1: 02/09/2022 NOT FOR CONSTRUCTION. THE DEVELOPERS RESERVE THE RIGHT TO AMEND ANY ASPECT OF THESE TECHNICAL LOT DRAWINGS AT ANYTIME WITHOUT PRIOR NOTICE. TOPOGRAPHICAL INFORMATION FOR CONCEPTUAL DESIGN PURPOSES ONLY.